

FOR DRAWING APPROVAL
FABRICATION AND MANUFACTURE WILL NOT COMMENCE UNTIL WRITTEN APPROVAL OF THIS DRAWING HAS BEEN RECEIVED. ANY DELAY IN RETURNING THE APPROVAL DRAWING CAN RESULT IN A DELAY IN THE DISPATCH OF THE EQUIPMENT.

APPROVED BY: [] DATE: []

APPROVED COMMENTS: [] DISAPPROVAL: []

PLEASE SIGN,DATE AND TICK THE APPROPRIATE BOX AND RETURN AS SOON AS POSSIBLE, WE WOULD EXPECT RECEIPT OF APPROVAL WITHIN 2 DAYS.

REVISIONS

ZONE	REV.	DESCRIPTION	DATE	APPROVED
	1	APPROVAL ISSUE		

VIBRATOR TORQUE SETTING – 56kgm/411ft–ib
SET CENTRIFUGAL FORCE TO 90%
M22 x 140mm BOLTS

STAINLESS STEEL LINER PLATES

ADJUSTABLE ANGLE SPRING BRACKETS

Information table

	1000	Rpm
Frequency	8.5mm	mm
Amplitude	20	Amps per vibrator
Starting current	4.5	Amps per vibrator
Full load current	2200	Watts per vibrator
Power	400,3,50	Volts,Phase,HZ
Electrical supply	1140	Kg
Equipment weight	460	Per spring bracket
Max static load (kg)	37	Per spring bracket
Max Dynamic load (kg+/-)		
Finish paint colour	RAL 7024 GREY	

NOTES:

1.0 N/A

2.0 N/A

3.0 N/A

4.0 N/A

5.0 TECHNICAL DELIVERY

5.1 TORQUE STANDARD TO UNLESS OTHERWISE STATED

Vibraplant.co.uk

Screening + Feeding + Conveying + Compaction Equipment

THIS DRAWING IS THE PROPERTY OF VIBRAPLANT LTD AND AS SUCH SHOULD NOT BE DISCLOSED, COPIED OR USED FOR MANUFACTURING PURPOSES WITHOUT THE WRITTEN CONSENT OF THE COMPANY.

REVISION: 1

DO NOT SCALE DRAWING

TITLE:

Open Vibratory Feeder
Model-FR02-1000-2600

DWG NO.
FR02-VP18125-01-GA-01

SHEET SCALE: 1:10

SHEET 1 OF 5

NOTES FOR INSTALLATION
(See manual ofr full details)

- 1) ENSURE THE EQUIPMENT IS MOUNTED ON A FIRM AND LEVEL SURFACE.
- 2) BOLT THE EQUIPMENT DOWN ENSURING A MINIMUM CLEARANCE OF 50mm BETWEEN STATIC OBJECTS AND 75mm BETWEEN OTHER VIBRATORY OBJECTS.
- 3) ONCE INSTALLED ENSURE SPRING BRACKETS ARE LEVEL; REMOVE THE TRANSPORT STRAPS AND FIT SPRING RETAINING STRAPS.
- 4) BEFORE STARTING ENSURE THE UNIT CAN MOVE FREELY ON THE SPRINGS.
- 5) WHEN STARTING CHECK THE VIBRATORS ARE ROTATING IN THE CORRECT DIRECTION.
- i) SINGLE VIBRATORS WOULD NORMALLY ROTATE IN A 'WITH FLOW' DIRECTION TO INCREASE MACHINETHROUGHPUT. HOWEVER IF INCREASED RETENTIONTIME IS PREFERRED THEN THE VIBRATOR CAN BE REVERSED TO 'COUNTER-FLOW'.
- 6) AFTER APPROXIMATELY 4 HOURS OPERATION CHECK THE FOLLOWING:
- ii) RE-TORQUE THE VIBRATOR FASTENERS IN ACCORDANCE WITH THE TORQUE SETTINGS STATED INTHE VIBRATOR MANUAL..
- iii) RE-TORQUE THE SPRING BRACKET BOLTS IN ACCORDANCE WITH THE TORQUE SETTING STATED IN THE EQUIPMENT MANUAL..

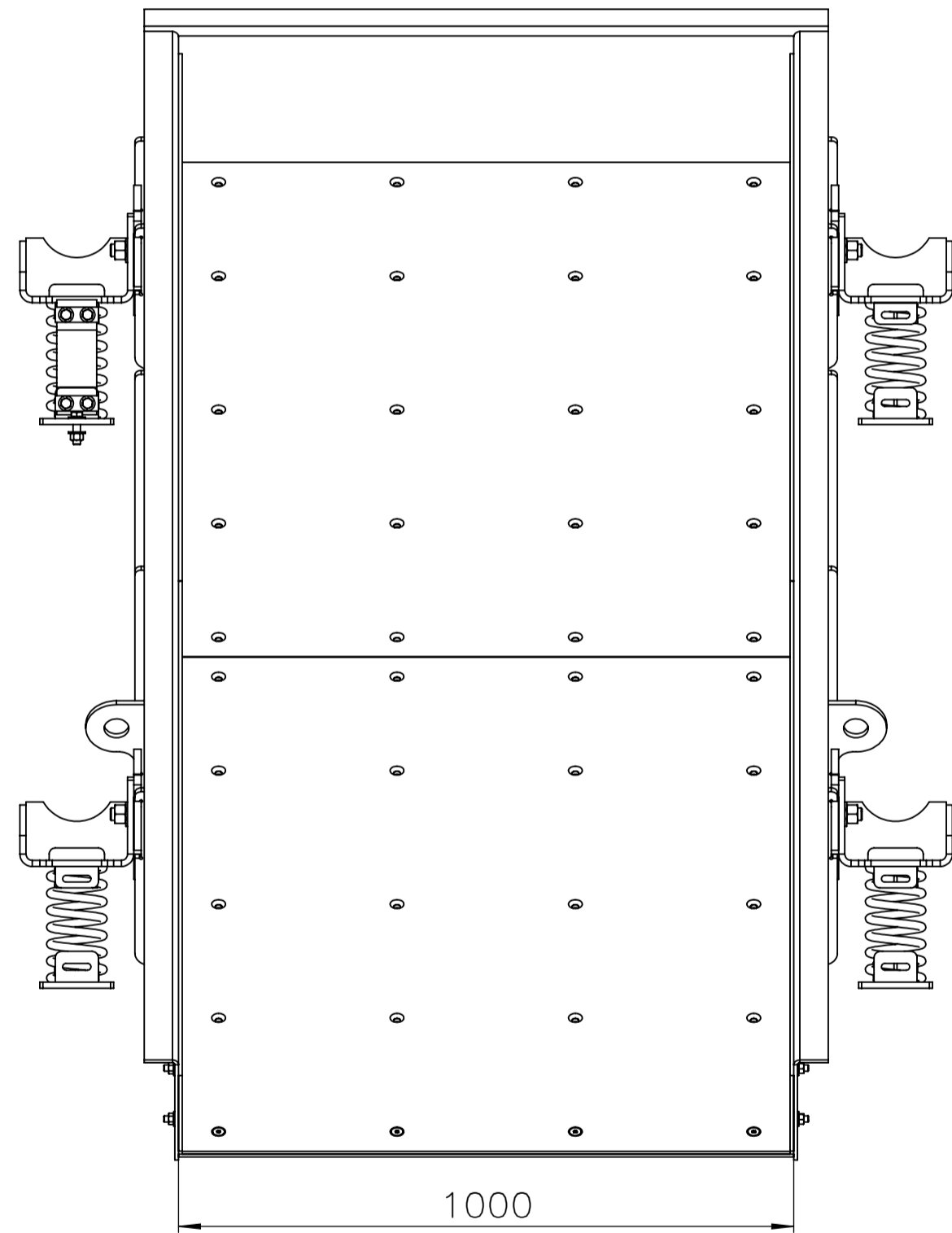
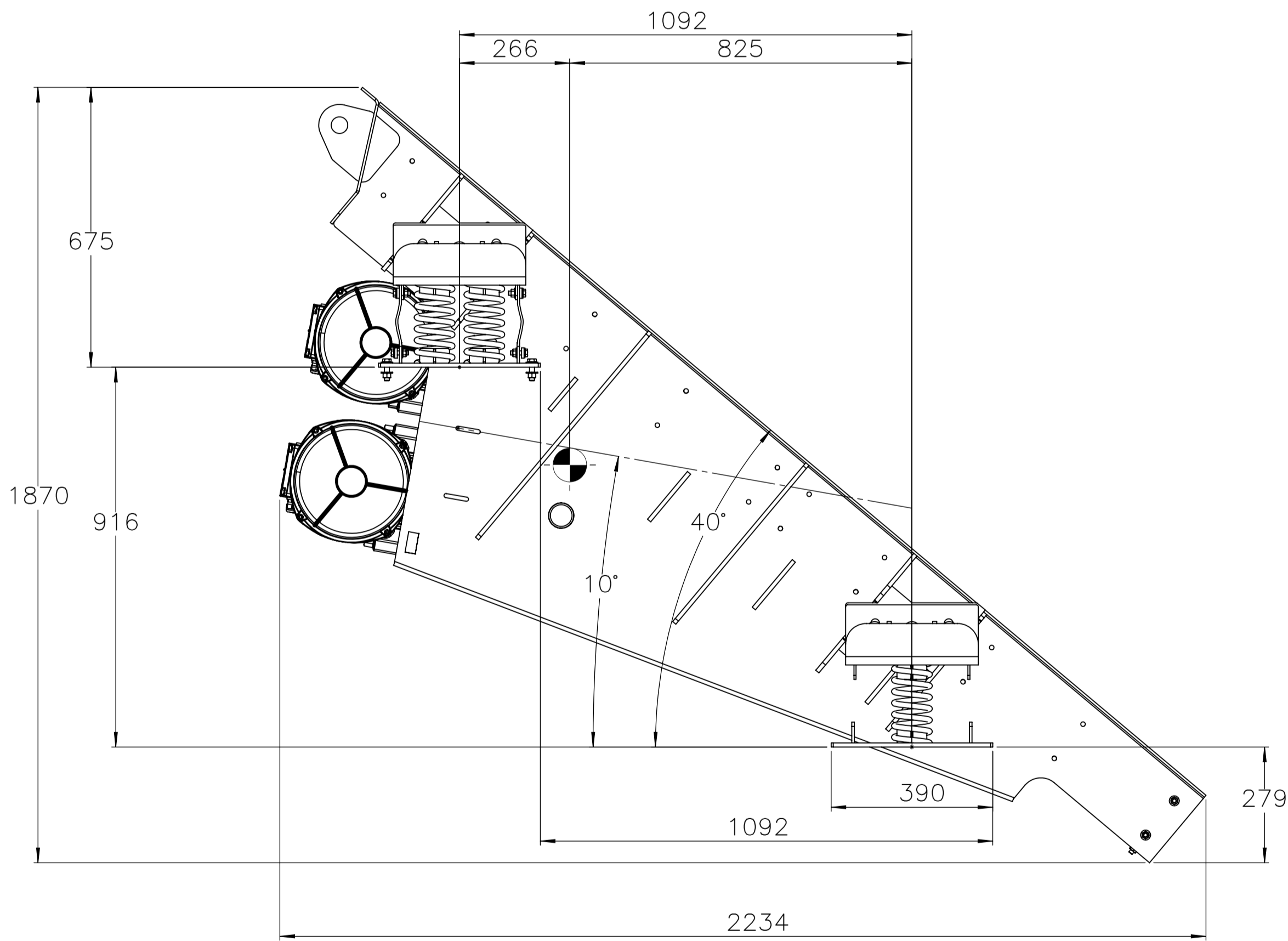
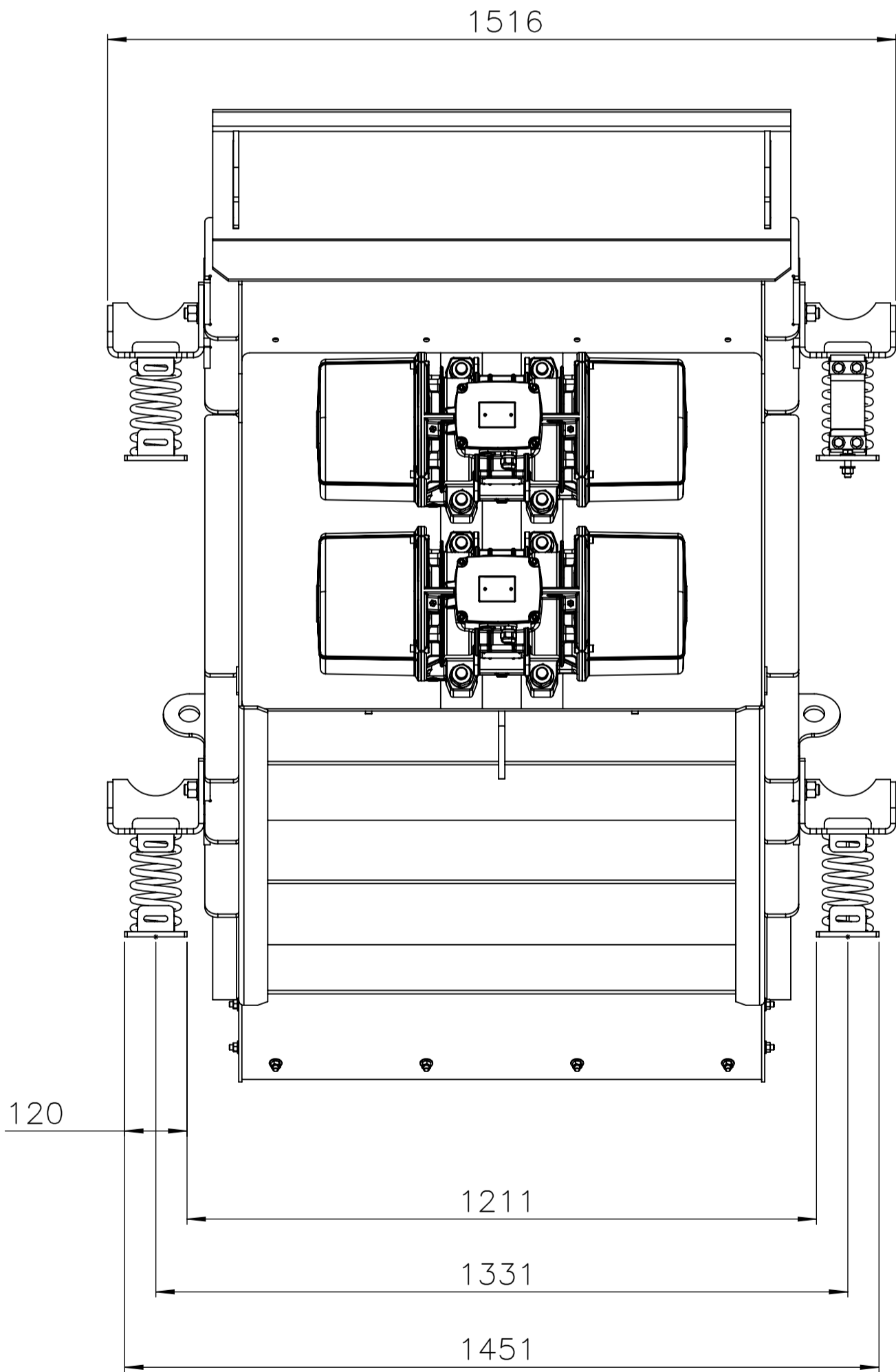
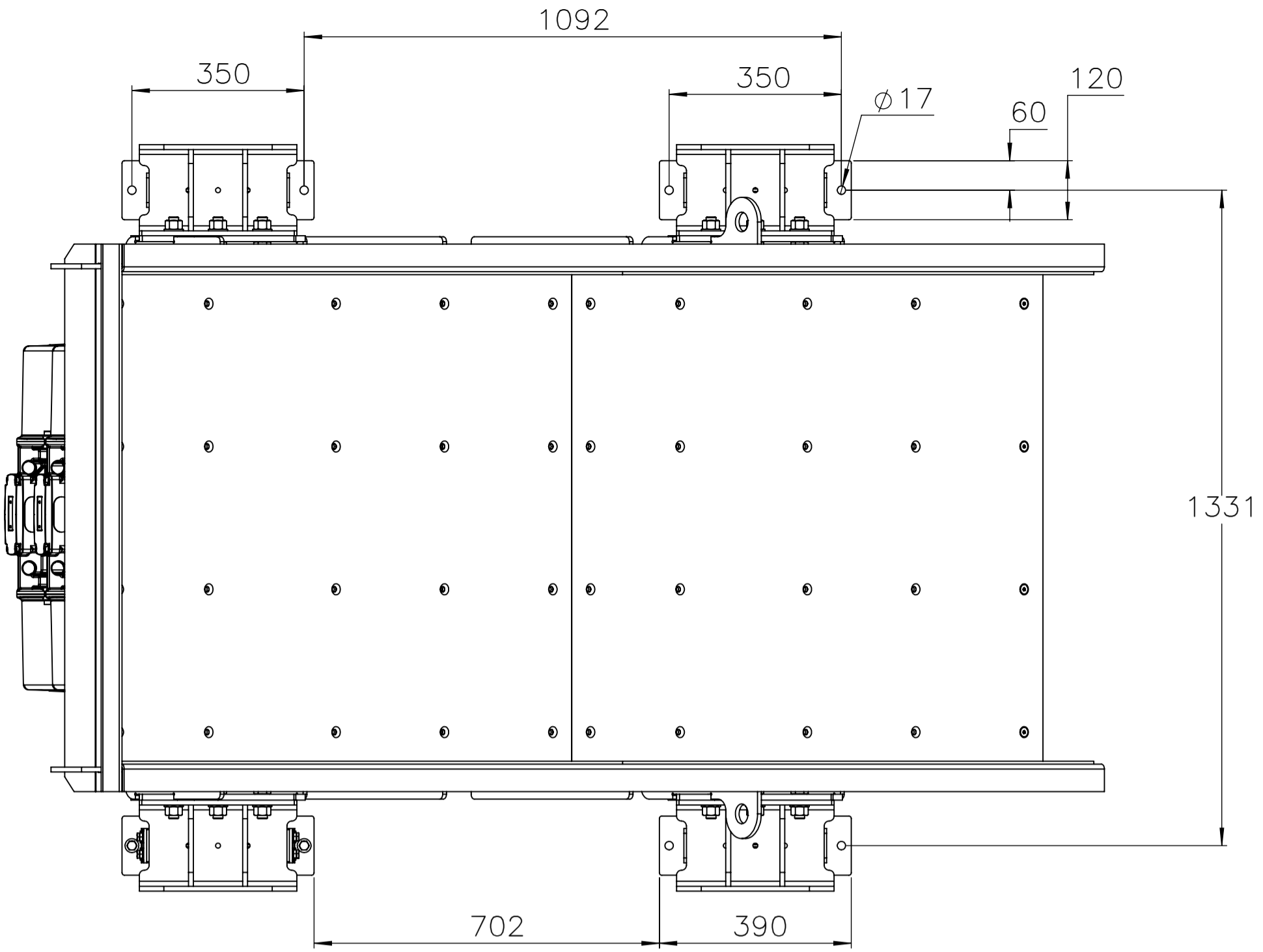

NOTES:
REFER TO SHEET ONE FOR NOTES.



THIS DRAWING IS THE PROPERTY OF VIBRAPLANT LTD AND AS SUCH SHOULD NOT BE DISCLOSED, COPIED OR USED FOR MANUFACTURING PURPOSES WITHOUT THE WRITTEN CONSENT OF THE COMPANY.

REVISION: 1

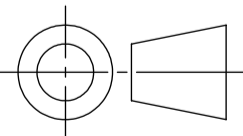

DO NOT SCALE DRAWING

TITLE:

	NAME	DATE
DRAWN	MM	26/11/2018
CHK'D	JH	

Open Vibratory Feeder
Model-FR02-1000-2600

TOLERANCES:

DWG NO.
FR02-VP18125-01-GA-
01

SHEET SCALE: 1:10

A1

SHEET 2 OF 5

	16	15	14	13	
ITEM NO.	PART NUMBER	DESCRIPTION		Default40Degree s/QTY.	REV
1	FR02-18125-WA-001	BODY WELDED ASSEMBLY		1	
2	FR02-18125-WA-004	Upper spring mount assembly two springs		2	
3	70-DSML-002-GA	Lower spring mount two springs		2	
4	100-00001-17	Compression Spring		6	
5	SM-STD-008	Strap plate		4	
6	FR02-18125-019	Feed off side liner		2	
7	FR02-18125-020	infeed side liner		1	
8	FR02-18125-020	infeed side liner		1	
9	FR02-18125-018	Base plate		2	
10	100-00057	Canvas Strap		2	
11	M22 BZP - Form C	Plain Washer		8	
12	M20 BZP - Form C	Plain Washer		12	
13	M10 BZP - Form C	Plain Washer		144	
14	M12 BZP - Form C	Plain Washer		16	
15	M22 BZP Nyloc Nut	Nyloc Nut		8	
16	M20 BZP Nyloc Nut	Nyloc Nut		12	
17	M10 BZP Nyloc Nut	Nyloc Nut		112	
18	M12 BZP Nyloc Nut	Nyloc Nut		8	
19	M22 x 140 BZP	Hex Head Bolt 8.8		8	
20	MVSI 10-3000-S02	Motor		2	
21	M10 x 35 BZP	Hex Head Screw 8.8		32	
22	M12 x 45 BZP	Hex Head Screw 8.8		8	
23	M10 x 30 BZP	Socket CSK 8.8		80	
24	FR02-18125-WA-005	Upper spring mount assembly one springs		2	
25	FR02-18125-WA-006	Lower spring mount one spring		2	

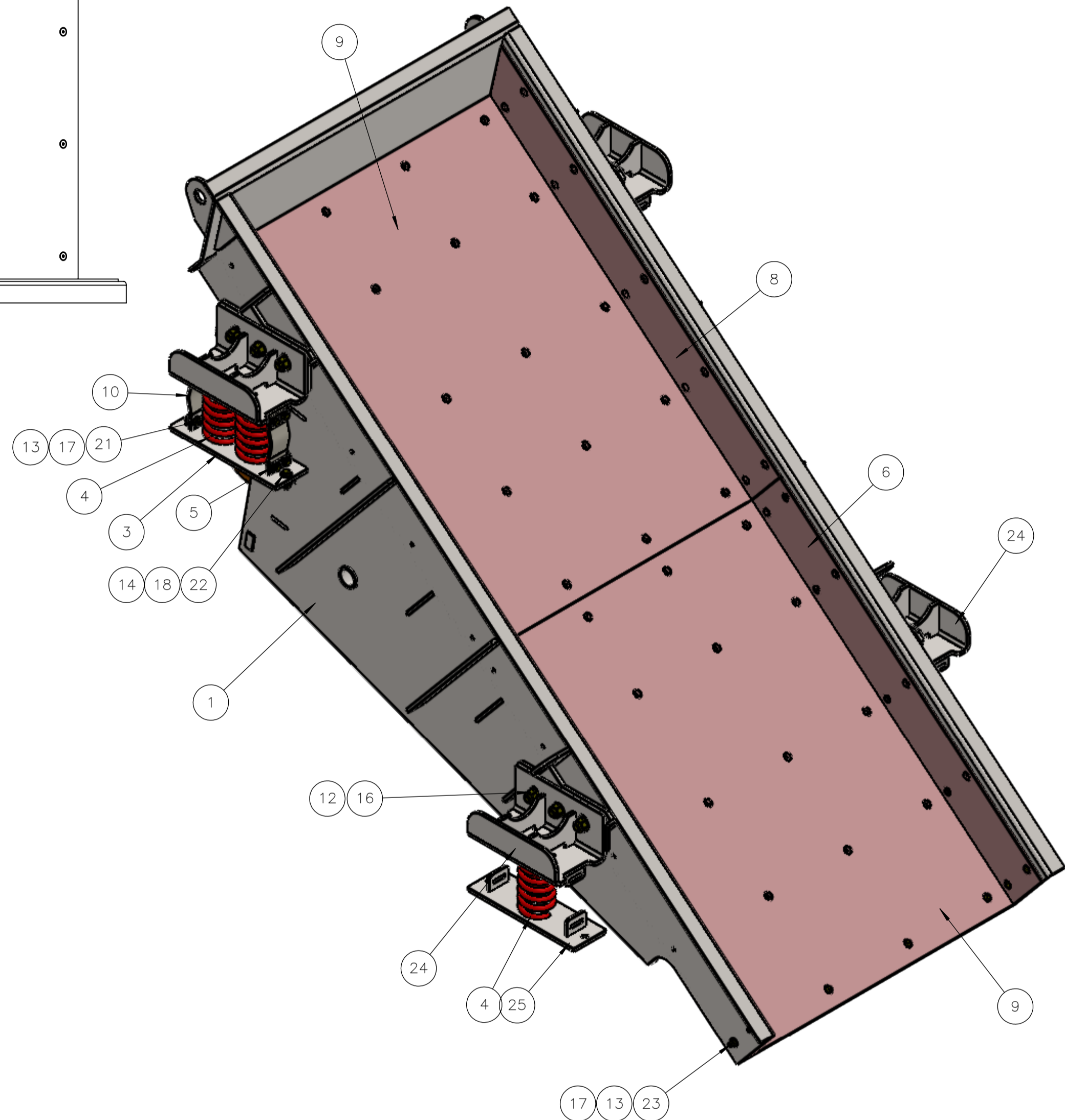
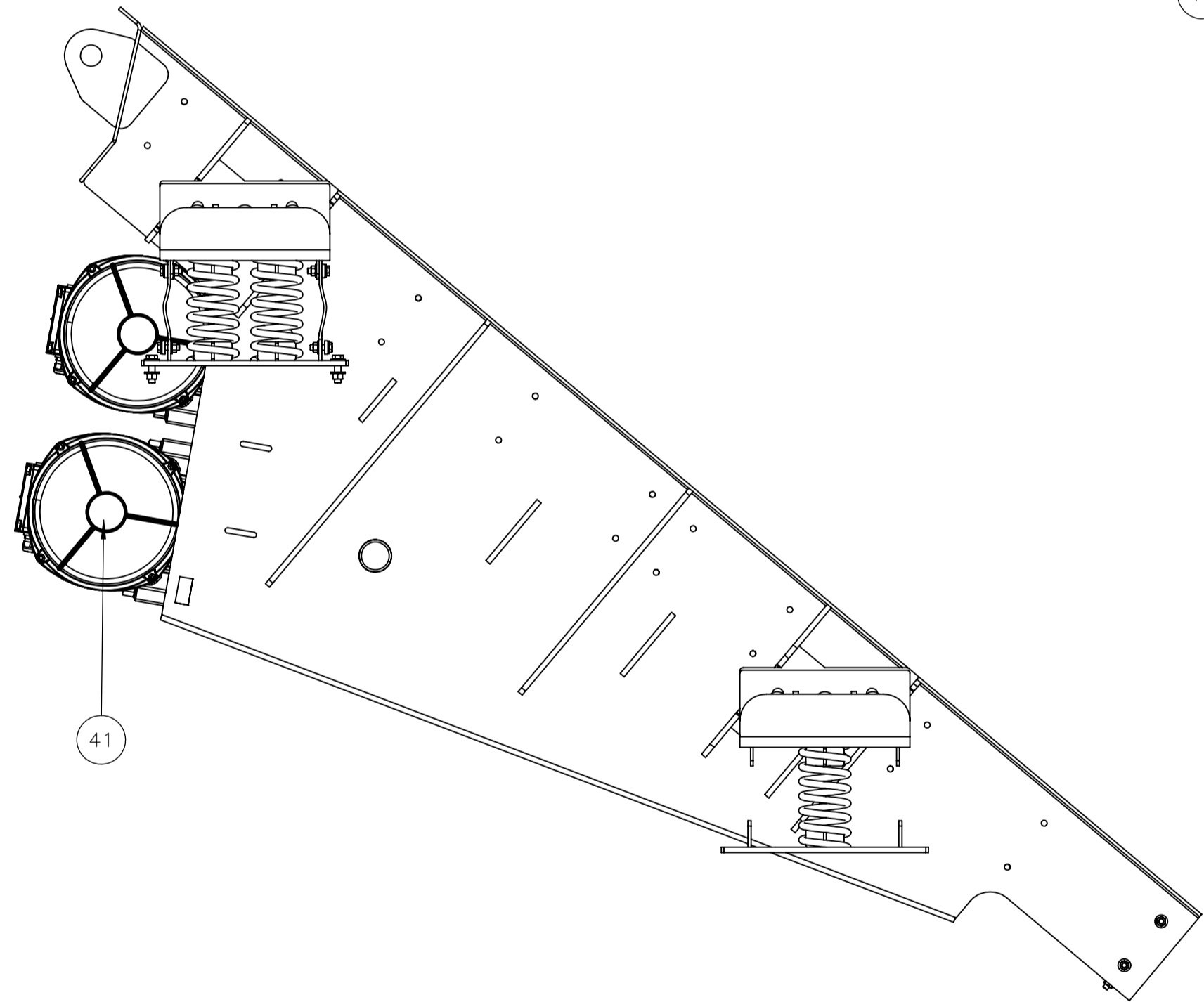
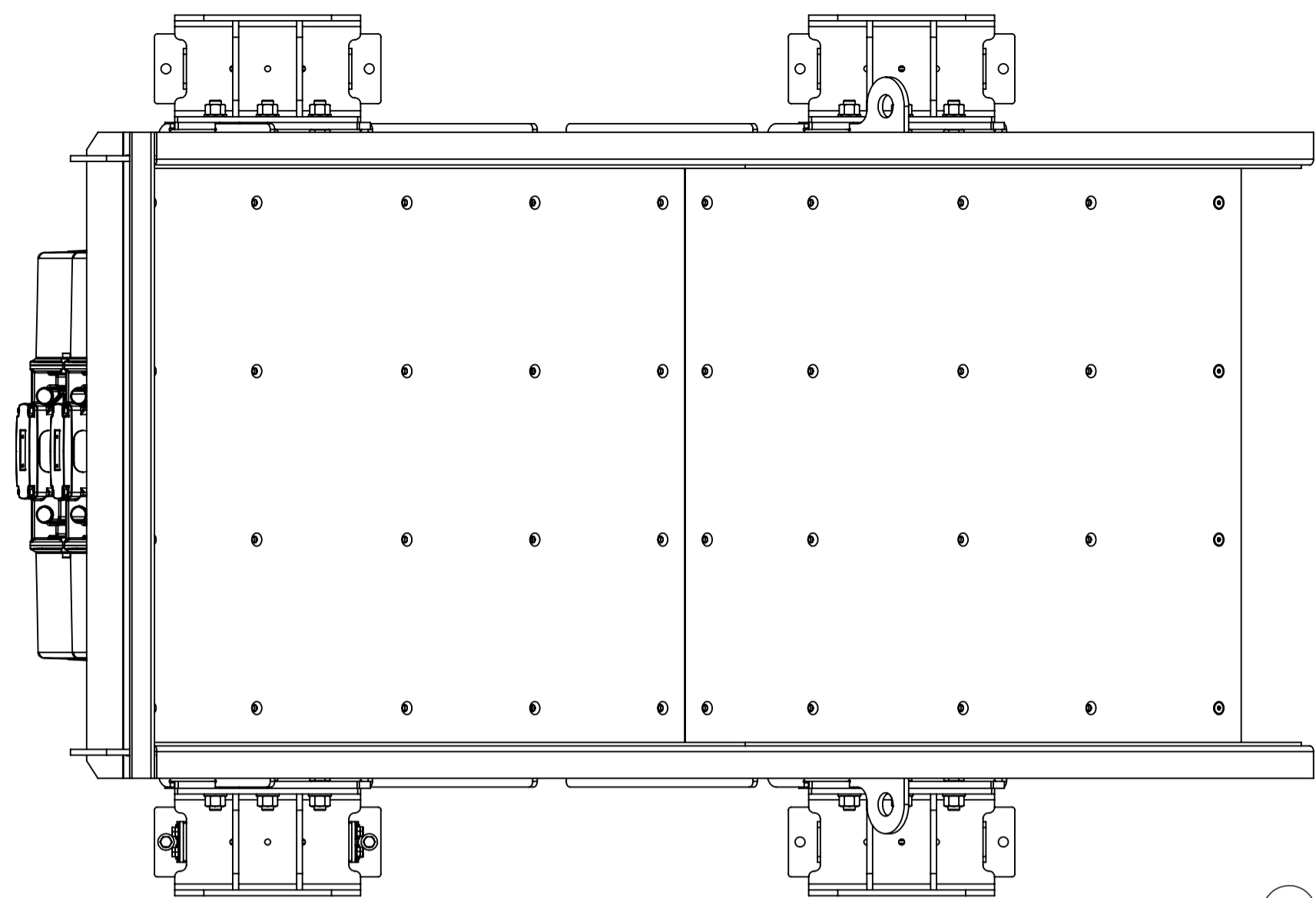
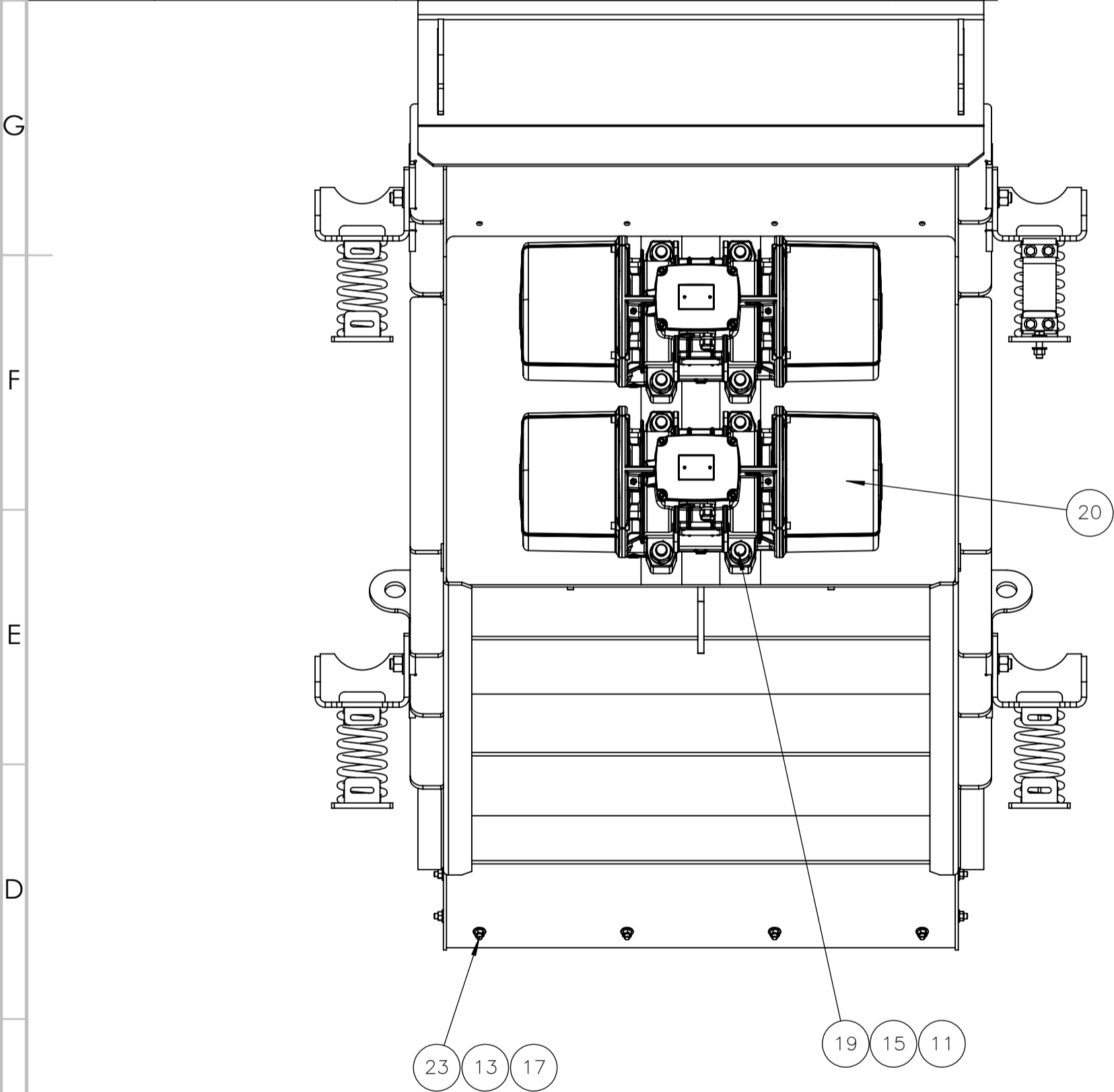

NOTES:
REFER TO SHEET ONE FOR NOTES.



THIS DRAWING IS THE PROPERTY OF VIBRAPLANT LTD AND AS SUCH SHOULD NOT BE DISCLOSED, COPIED OR USED FOR MANUFACTURING PURPOSES WITHOUT THE WRITTEN CONSENT OF THE COMPANY.

REVISION: 1

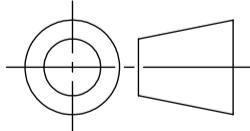

DO NOT SCALE DRAWING

TITLE:

	NAME	DATE
DRAWN	MM	26/11/2018
CHK'D	JH	

Open Vibratory Feeder
Model-FR02-1000-2600

TOLERANCES:

DWG NO.
FR02-VP18125-01-GA-01

A1

SHEET SCALE: 1:10

SHEET 3 OF 5

NOTES FOR INSTALLATION
(See manual ofr full details)

- 1) ENSURE THE EQUIPMENT IS MOUNTED ON A FIRM AND LEVEL SURFACE.
- 2) BOLT THE EQUIPMENT DOWN ENSURING A MINIMUM CLEARANCE OF 50mm BETWEEN STATIC OBJECTS AND 75mm BETWEEN OTHER VIBRATORY OBJECTS.
- 3) ONCE INSTALLED ENSURE SPRING BRACKETS ARE LEVEL; REMOVE THE TRANSPORT STRAPS AND FIT SPRING RETAINING STRAPS.
- 4) BEFORE STARTING ENSURE THE UNIT CAN MOVE FREELY ON THE SPRINGS.
- 5) WHEN STARTING CHECK THE VIBRATORS ARE ROTATING IN THE CORRECT DIRECTION.
- i) SINGLE VIBRATORS WOULD NORMALLY ROTATE IN A 'WITH FLOW' DIRECTION TO INCREASE MACHINETHROUGHPUT. HOWEVER IF INCREASED RETENTIONTIME IS PREFERRED THEN THE VIBRATOR CAN BE REVERSED TO 'COUNTER-FLOW'.
- 6) AFTER APPROXIMATELY 4 HOURS OPERATION CHECK THE FOLLOWING:
- ii) RE-TORQUE THE VIBRATOR FASTENERS IN ACCORDANCE WITH THE TORQUE SETTINGS STATED INTHE VIBRATOR MANUAL..
- iii) RE-TORQUE THE SPRING BRACKET BOLTS IN ACCORDANCE WITH THE TORQUE SETTING STATED IN THE EQUIPMENT MANUAL..

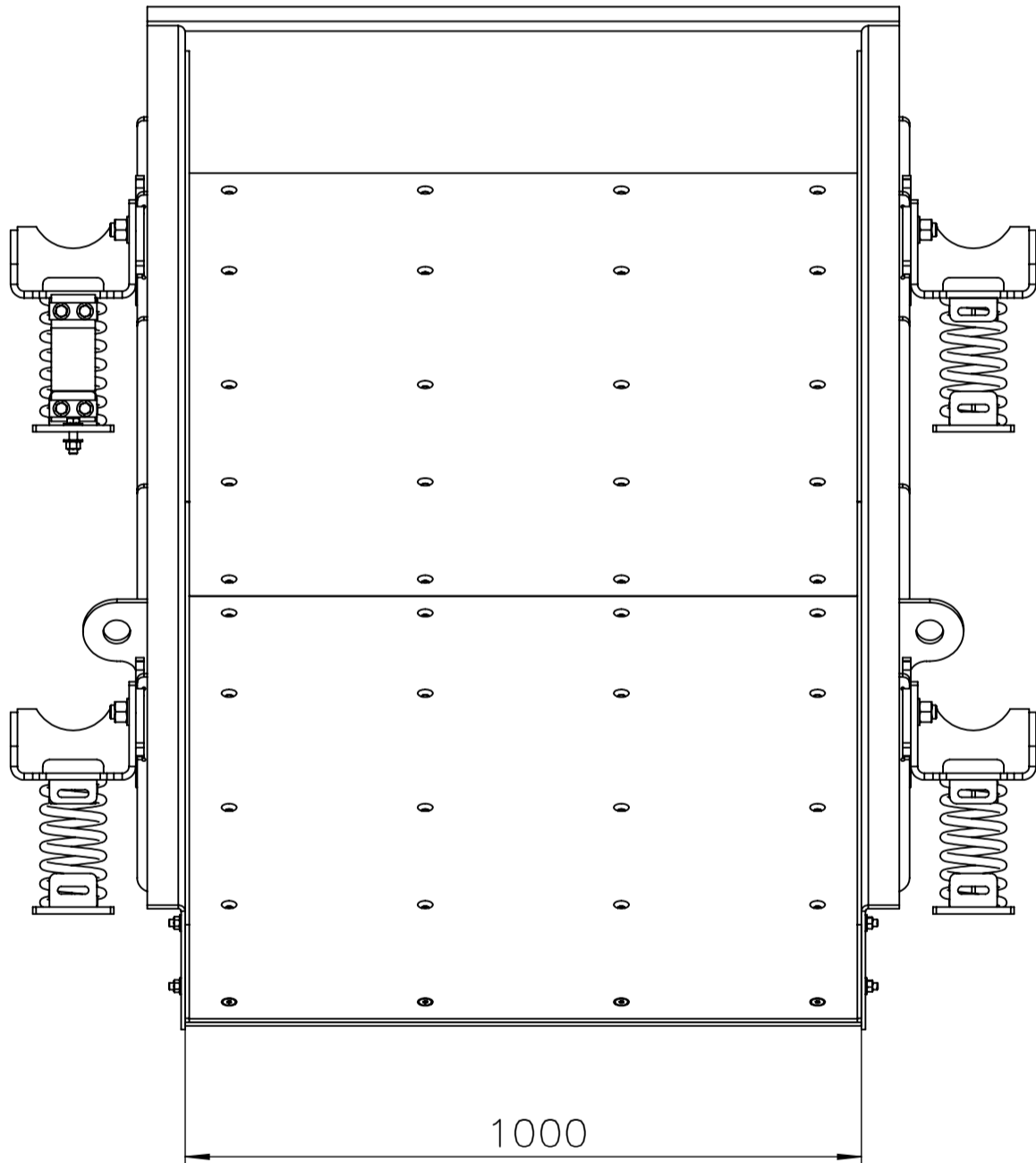
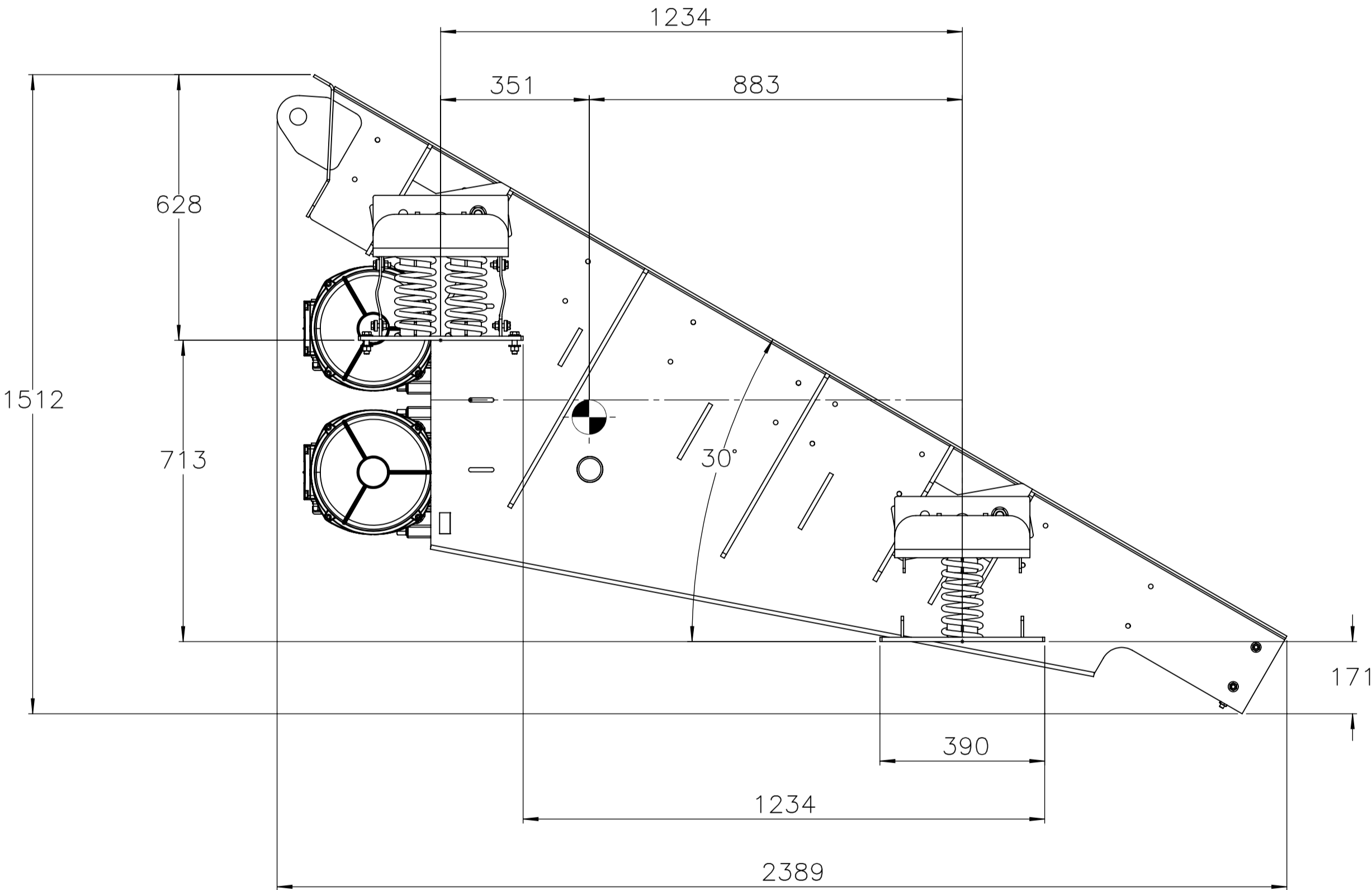
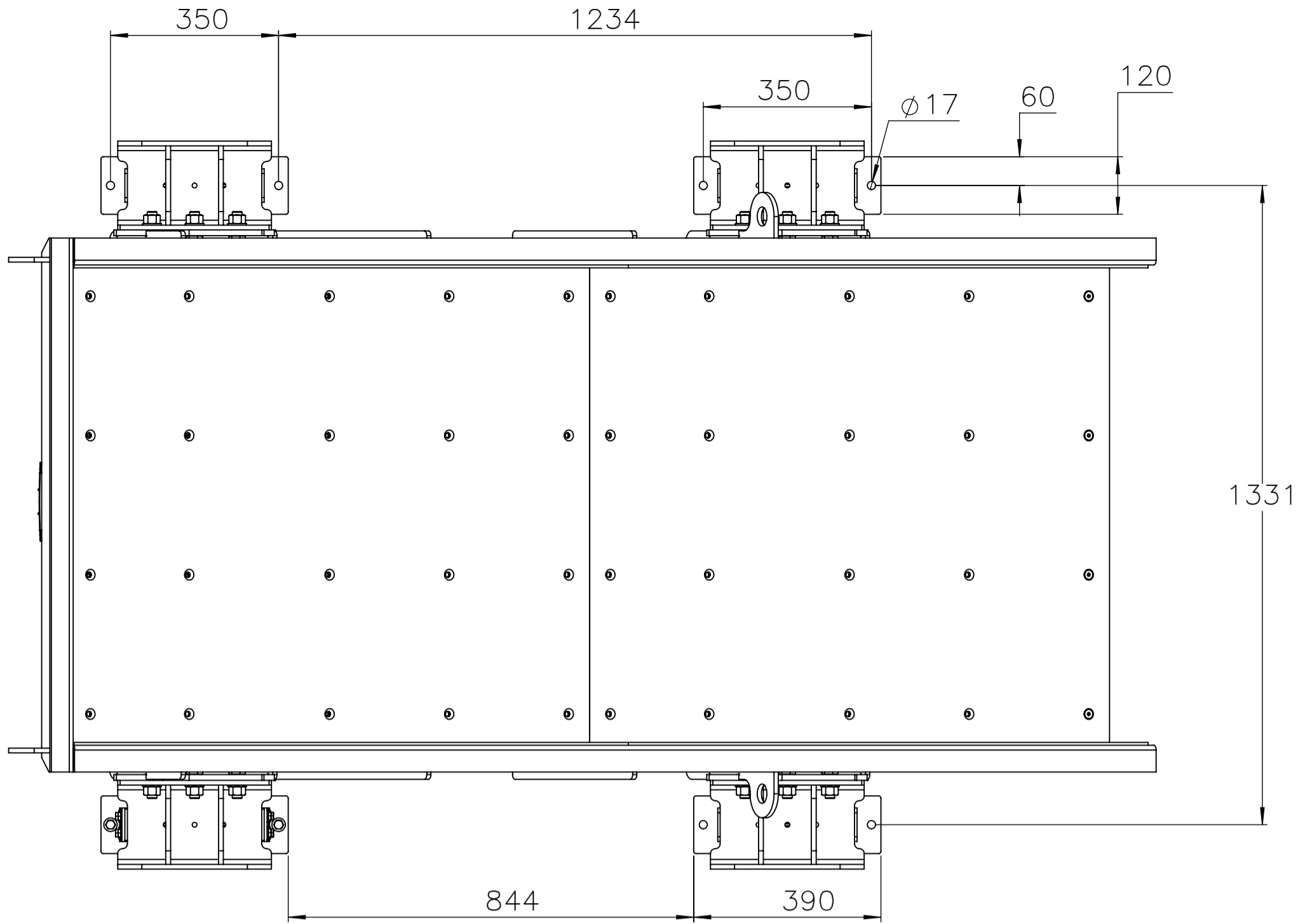
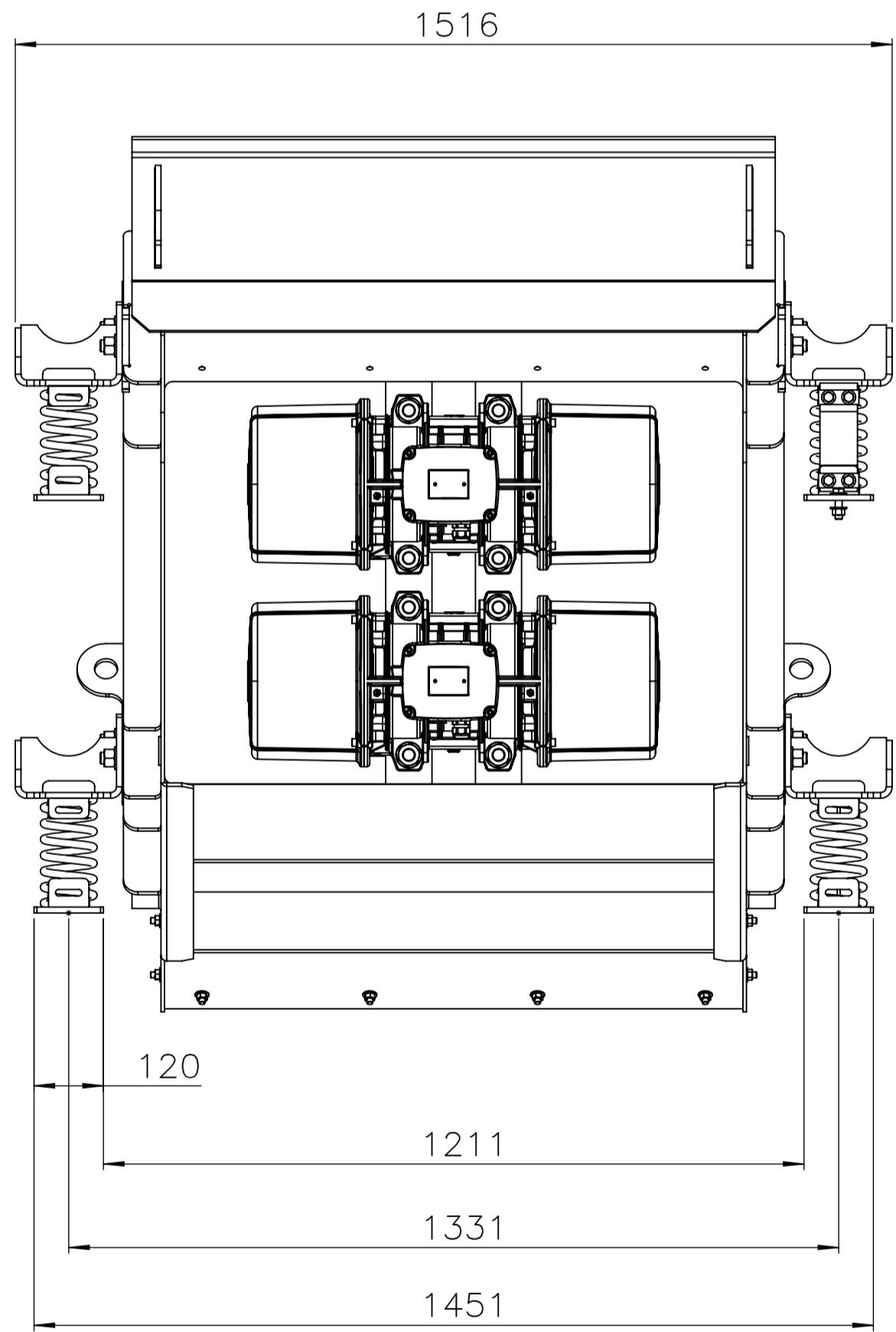

NOTES:
REFER TO SHEET ONE FOR NOTES.



THIS DRAWING IS THE PROPERTY OF VIBRAPLANT LTD AND AS SUCH SHOULD NOT BE DISCLOSED, COPIED OR USED FOR MANUFACTURING PURPOSES WITHOUT THE WRITTEN CONSENT OF THE COMPANY.

REVISION: 1

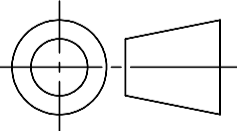

DO NOT SCALE DRAWING

TITLE:

	NAME	DATE
DRAWN	MM	26/11/2018
CHK'D	JH	

Open Vibratory Feeder
Model-FR02-1000-2600

TOLERANCES:

DWG NO.
FR02-VP18125-01-GA-
01

A1

SHEET SCALE: 1:10

SHEET 4 OF 5

NOTES FOR INSTALLATION
(See manual ofr full details)

- 1) ENSURE THE EQUIPMENT IS MOUNTED ON A FIRM AND LEVEL SURFACE.
- 2) BOLT THE EQUIPMENT DOWN ENSURING A MINIMUM CLEARANCE OF 50mm BETWEEN STATIC OBJECTS AND 75mm BETWEEN OTHER VIBRATORY OBJECTS.
- 3) ONCE INSTALLED ENSURE SPRING BRACKETS ARE LEVEL; REMOVE THE TRANSPORT STRAPS AND FIT SPRING RETAINING STRAPS.
- 4) BEFORE STARTING ENSURE THE UNIT CAN MOVE FREELY ON THE SPRINGS.
- 5) WHEN STARTING CHECK THE VIBRATORS ARE ROTATING IN THE CORRECT DIRECTION.
- i) SINGLE VIBRATORS WOULD NORMALLY ROTATE IN A 'WITH FLOW' DIRECTION TO INCREASE MACHINETHROUGHPUT. HOWEVER IF INCREASED RETENTIONTIME IS PREFERRED THEN THE VIBRATOR CAN BE REVERSED TO 'COUNTER-FLOW'.
- 6) AFTER APPROXIMATELY 4 HOURS OPERATION CHECK THE FOLLOWING:
- ii) RE-TORQUE THE VIBRATOR FASTENERS IN ACCORDANCE WITH THE TORQUE SETTINGS STATED INTHE VIBRATOR MANUAL..
- iii) RE-TORQUE THE SPRING BRACKET BOLTS IN ACCORDANCE WITH THE TORQUE SETTING STATED IN THE EQUIPMENT MANUAL..

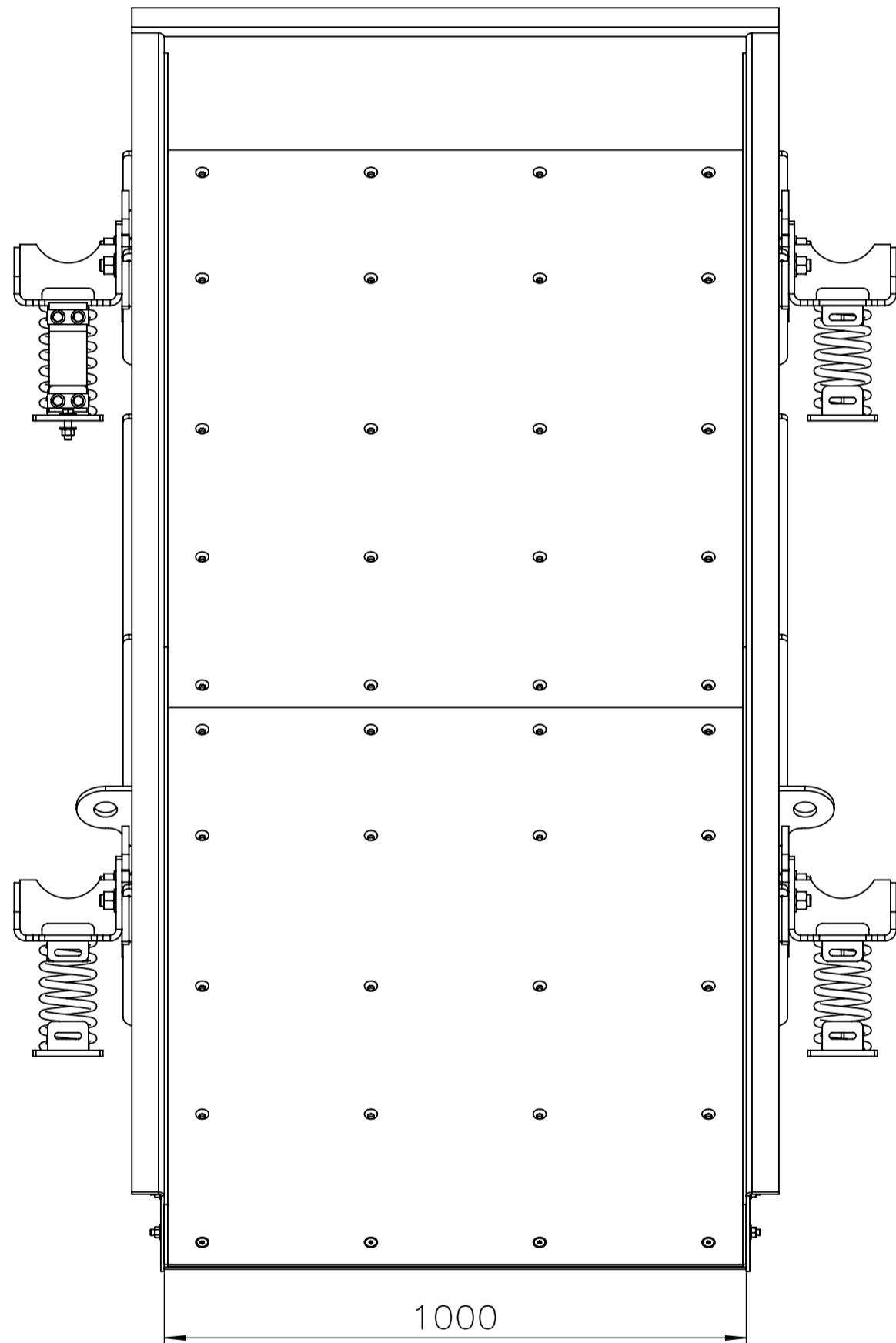
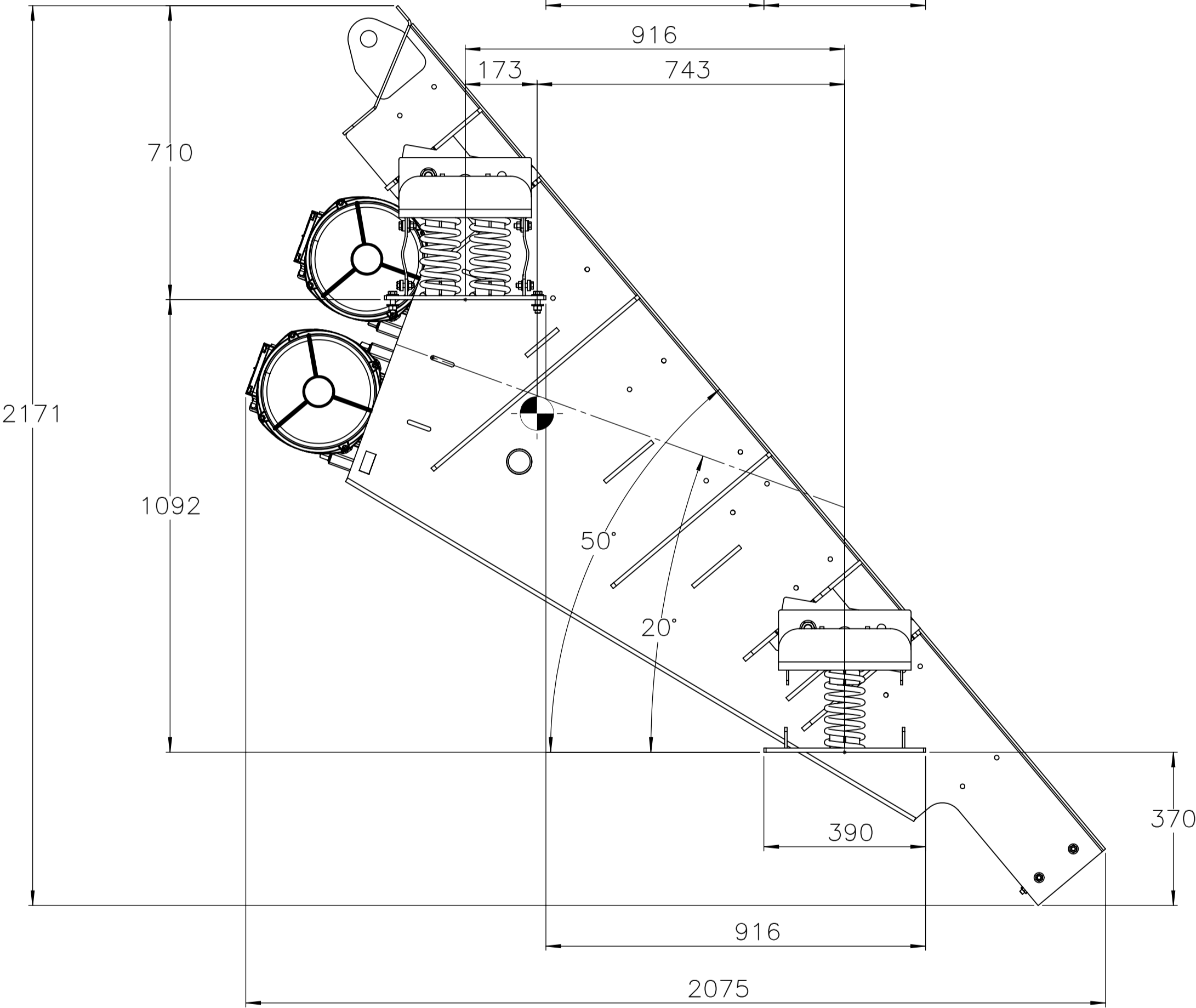
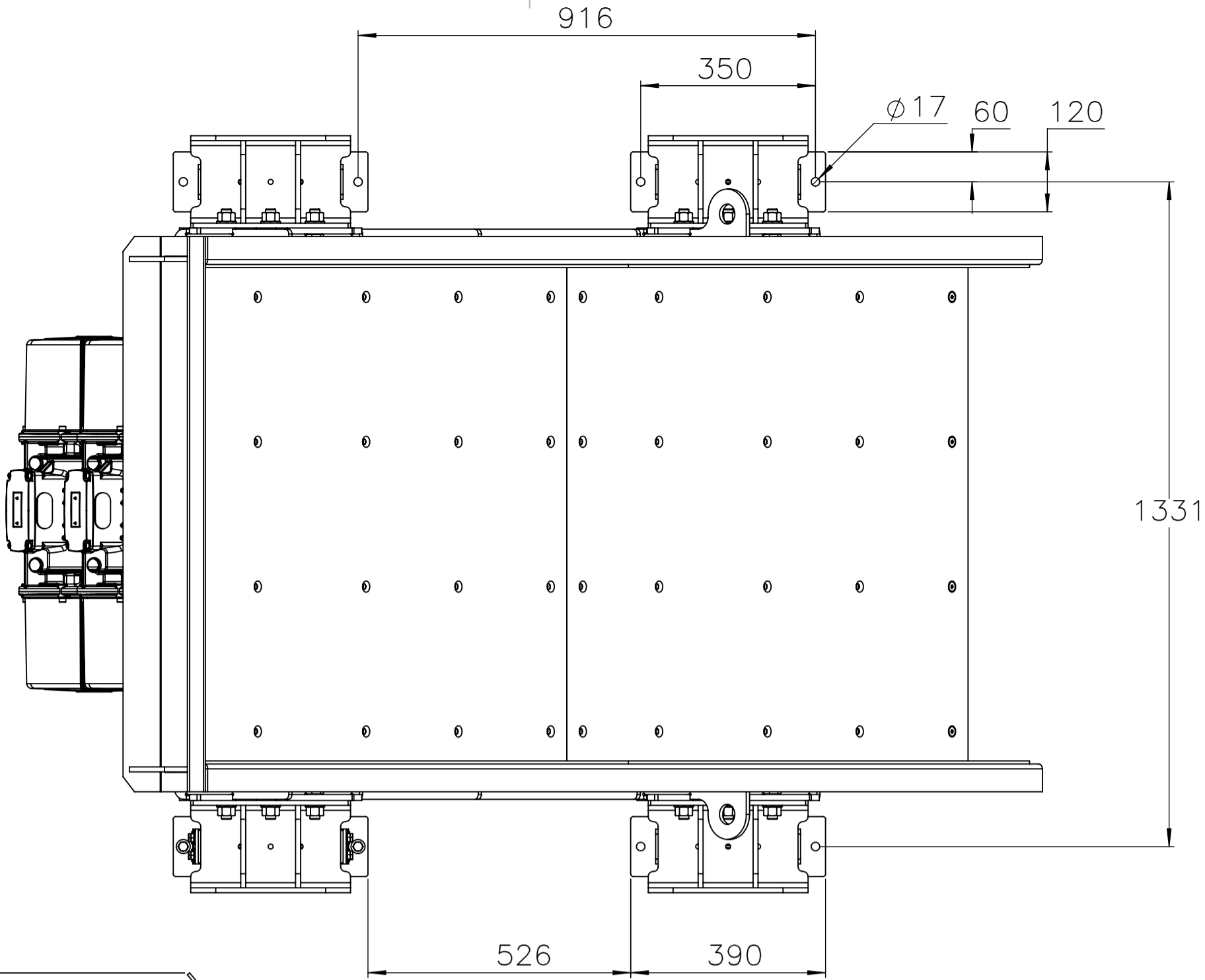
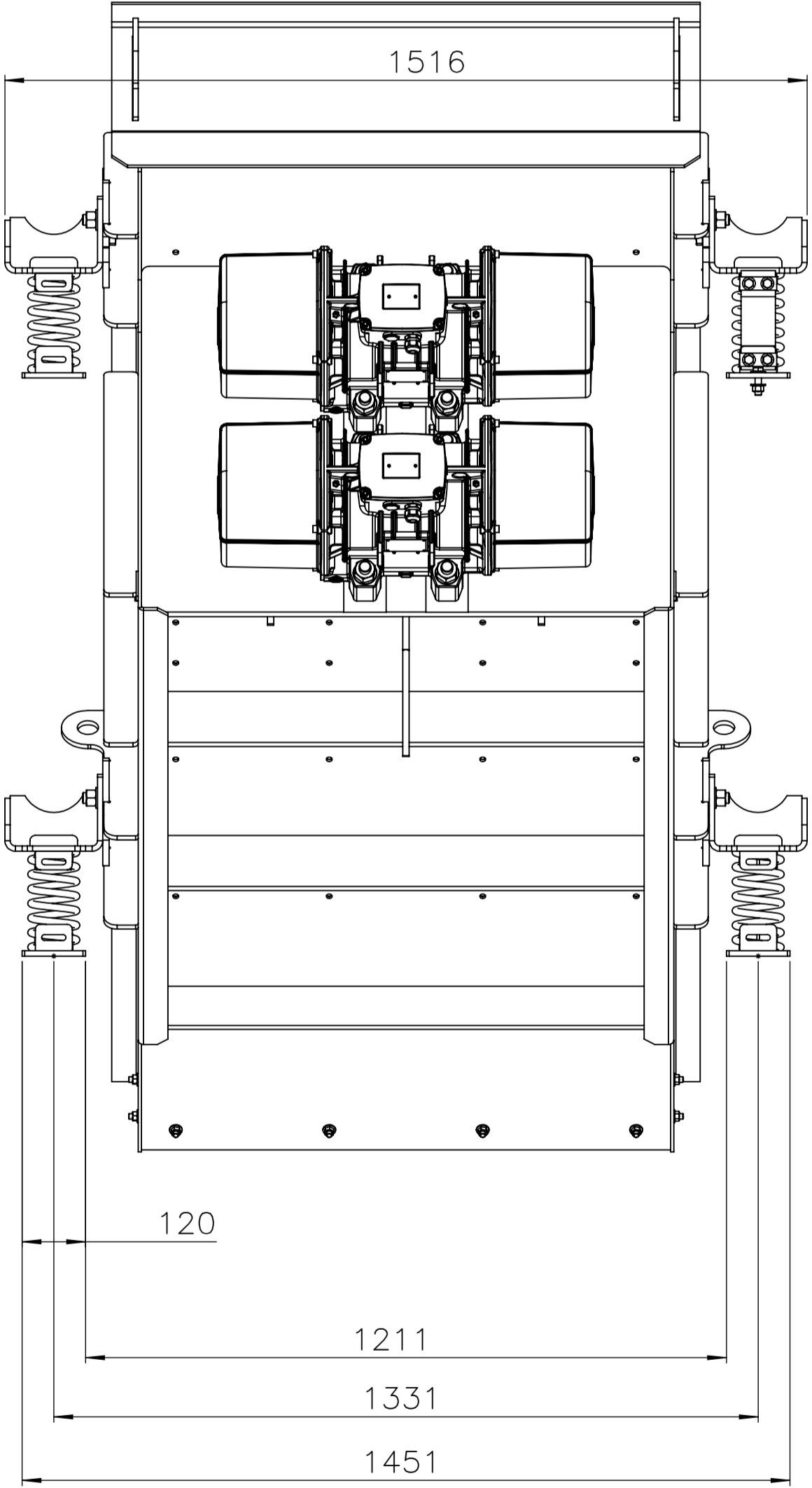

NOTES:
REFER TO SHEET ONE FOR NOTES.



THIS DRAWING IS THE PROPERTY OF VIBRAPLANT LTD AND AS SUCH SHOULD NOT BE DISCLOSED, COPIED OR USED FOR MANUFACTURING PURPOSES WITHOUT THE WRITTEN CONSENT OF THE COMPANY.

REVISION: 1

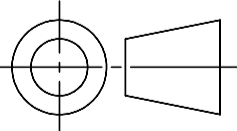

DO NOT SCALE DRAWING

TITLE:

	NAME	DATE
DRAWN	MM	26/11/2018
CHK'D	JH	

TOLERANCES:

Open Vibratory Feeder
Model-FR02-1000-2600

DWG NO.
FR02-VP18125-01-GA-01

SHEET SCALE: 1:10

A1

SHEET 5 OF 5